

PERIOD HOMES

By Simon Miller



Vanity Lane

Linton, Maidstone ME17 4BP

- Former Victorian Farm Building
- Exclusive Development Of 5 Homes
 - Triple Aspect Lounge
 - Kitchen/Breakfast Room
- Triple Car Port With Direct Access To The Kitchen
- Grade II Listed
- Five Bedrooms
- Dining Room
- Mature Gardens Offering Extensive Views
- Edge Of Linton Village

Offers In Excess Of £650,000 Freehold

Local Authority Maidstone
Borough Council
Council Tax Band G
EPC Rating

Rose Court, Vanity Lane, Linton, Maidstone, ME17

Approximate Area = 2079 sq ft / 193.1 sq m

For identification only - Not to scale



FIRST FLOOR

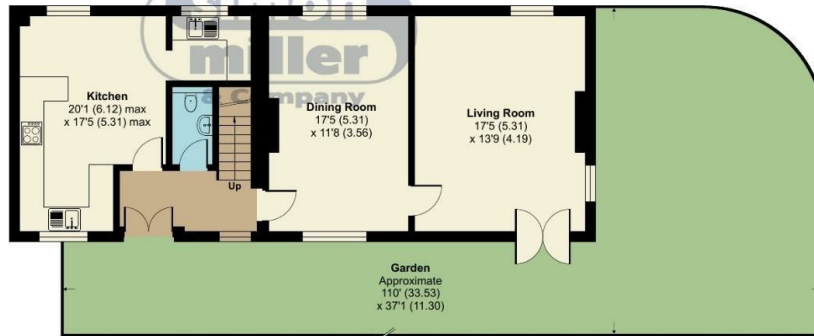

GROUND FLOOR



Floor plan produced in accordance with RICS Property Measurement Standards incorporating International Property Measurement Standards (IPMS2 Residential). © nichecom 2023. Produced for Simon Miller & Company. REF: 990666

Period Homes by Simon Miller Office
Weald, 5 High Street, Headcorn, Ashford,
Kent, TN27 9NH

Contact

01622 850888
admin@periodhomesbysimonmiller.co.uk
<https://simonmiller.co.uk/period-homes/>

Agents Note: Whilst every care has been taken to prepare these particulars, they are for guidance purposes only. All measurements are approximate and for general guidance purposes only and whilst every care has been taken to ensure accuracy, they should not be relied upon and potential buyers/tenants are advised to recheck the measurements.

